

EdgeStar IP200 Series Ice Makers: How to Replace the Control Panel Board

Before you begin, you will need a Phillips head screwdriver, sharp blade and the replacement control panel board.

Caution: Electric shock risk! Disconnect power before servicing!

1. Unplug the unit from power and drain the water.
2. Gently peel the front control panel sticker as to not break or damage the sticker as we do not have replacements. You may need a sharp blade or fingernails to initially get underneath the sticker. If carefully removed the sticker should have enough adhesive to reattach or you can use your own adhesive if you prefer.



3. Remove the control panel screws.

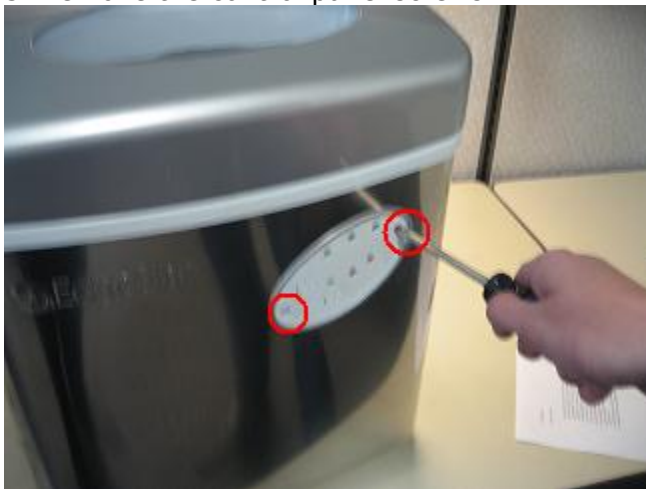

4. Pry the control panel out of its hole and bend down.



5. Remove the 4 screws holding the control panel board to the front cover.



6. Remove the wiring connector from the control panel board.



7. Discard the failed board and attach wiring connector to the replacement board.

8. Reassemble the unit by following the above instructions in reverse.